

A photograph of a modern building with a curved, elevated walkway. A person is walking on the walkway. The building has a glass facade and is surrounded by trees. The sky is clear and blue.

Backhouse Blunston, Swindon Annual Travel Plan Monitoring Report (July 2024 – July 2025)

Backhouse Housing
September 2025

Prepared for:

Backhouse

Annual Travel Plan Monitoring Report (July 2024 – July 2025) September 2025

Prepared by:

PFA Consulting
Stratton Park House
Wanborough Road
Swindon
SN3 4HG

Tel: 01793 828000
Email: enquiries@pfaconsulting.co.uk
Website: www.pfaconsulting.co.uk



DOCUMENT CONTROL

Job No	B770	
File Reference	G:\workfiles\B770 BLUNSDON\REPORTS\B770-DOC01 Annual Travel Plan Monitoring Report (July 2024 - July 2025).docx	
	Name	Date
Prepared By	H Pearce	22 September 2025
Checked By	J Alexander	22 September 2025

Issue	Approved by	Date	Comments
1	J Alexander	22 September 2025	For submission on Modeshift STARS

This document has been prepared for the exclusive use of the client in connection with the project and its copyright remains vested in PFA Consulting. Unless otherwise agreed in writing by PFA Consulting, no person or party may copy, reproduce, make use of or rely upon its contents other than for the purposes for which it was originally prepared and provided.

Opinions and information provided in this document have been provided using due care and diligence. It should be noted and is expressly stated that no independent verification of any information supplied to PFA Consulting has been made.

Warning: This document may contain coloured images which may not print satisfactorily in black and white. It may also contain images originally created at a size greater than A4 which may not print satisfactorily on small printers. If copying is authorised but difficulty is incurred in reproducing a paper copy of this document, or a scaled copy is required, please contact PFA Consulting. Authorisation for reproducing plans based upon Ordnance Survey information cannot be given.

© PFA Consulting Ltd 2025

CONTENTS

PAGE NO.

1.	INTRODUCTION	1
	Background	1
	Residential Travel Plan	1
	Outline of the Monitoring Report	1
2.	REVIEW OF PROGRESS	2
	Travel Plan Initiatives	2
	Travel Information Packs	3
3.	LOOKING AHEAD	4
	Updating Travel Plan on Modeshift STARS	4
	Engagement Events	4
	Travel Information Packs	4
	Cycle and Bus Incentives	4
	Travel Surveys & Monitoring	4
	Accreditation	4

APPENDICES

Appendix A	Travel Information Pack
Appendix B	Travel Plan Newsletter
Appendix C	Travel Plan Poster

1. INTRODUCTION

Background

- 1.1. This annual travel plan monitoring report for the Backhouse Housing development at 'Land at Hill Cottage, Blunsdon', referred to as 'Backhouse Blunsdon', has been prepared by PFA Consulting to provide a review of the Residential Travel Plan (RTP) for the latest 12-month period (July 2024-July 2025), following PFA Consulting's re-commission as the site's Travel Plan Coordinator (TPC).
- 1.2. This report is submitted to Backhouse Housing (the developer) as well as Claire Fleming, Swindon Borough Council's Travel Plan Officer, and has been uploaded to the Modeshift STARS platform.

Residential Travel Plan

- 1.3. The RTP for 'Backhouse Blunsdon' was first produced by PFA Consulting and approved by Swindon Borough Council (SBC) in December 2023. The RTP is an evolving document and is to remain active until 2028 or until successful completion of the travel plan targets at full occupation of the site, whichever is the later. SBC require all new travel plans to be included on the Modeshift STARS online platform, a national database for recording and updating travel plans.
- 1.4. The RTP covers a development of 90 dwellings; as of July 2025 a total of 54 dwellings have been occupied. It is anticipated that the development would be completed in earlier 2026.
- 1.5. An annual monitoring report is required to be produced throughout the travel plan's lifespan, as specified in the RTP. These are informative reports produced for the benefit of the developers and SBC to indicate what progress had been made over the past 12-months, and outline the plans for the following 12-month period.
- 1.6. The Backhouse Blunsdon Travel Plan currently has the 'Good Travel Plan' accreditation on Modeshift STARS, as approved by SBC's Travel Plan Officer.

Outline of the Monitoring Report

- 1.7. This monitoring report reviews the progress made with regards to the aims and objectives of the RTP and the specific Travel Plan Initiatives; and identifies the 'next steps' that are to be taken over the next 12-month period. This includes the continued production and distribution of the Travel Information Packs to residents on occupation, continued communication with all stakeholders, and measures proposed to encourage sustainable travel.

2. REVIEW OF PROGRESS

2.1. A review of the RTP is provided in this section, with the ‘Aims/Actions’ provided below in **Table 2.1**, which is replicated on Modeshift STARS.

Travel Plan Initiatives

Table 2.1: Backhouse Blunsdon RTP Modeshift STARS Travel Plan Initiatives

Travel Plan Initiative	Reference	Description
Cycle parking/ storage installed	BC6	Bike Storage Strategy approved in June 2022. All dwellings currently constructed have cycle storage as per the approved plans.
Installation of electric vehicle charging points	RC12	Electric vehicle charging points installed as per approved parking layout plan dated November 2022. All dwellings currently constructed are in accordance with the approved plans.
Dr Bike sessions delivered	BC16	Dr Bike sessions were offered as part of Sustainable Travel Event in October 2023. Another session is to be offered following full occupancy.
Bike security marking takes place	BC1	Bike security marking as part of Sustainable Travel Event in October 2023. Another session will be provided upon approach to full occupancy.
Offer led/guided cycle rides	BC21	As part of sustainable travel event in October 2023, a group led ride was organised by ‘Let’s Ride’ bike leaders. Links to British Cycling’s ‘Let’s Ride’ webpage (which shows free guided bike rides in local areas) is provided in the updated Travel Information Pack.
New residents welcome pack with travel information	BP14	On occupation all new residents are provided with the Travel Information Pack (TIP) containing a wealth of information on sustainable travel options available to them. The Travel Information Pack can also be accessed online via a QR code and link on a poster within the sales office, which is reproduced at Appendix A ; and also as a link on SBC’s ‘Swindon Travel Choices Website for the Backhouse, Blunsdon development: https://www.swindontravelchoices.co.uk/newdevelopments/backhouse-blunsdon/
Provision of timetables/maps/ Information	BPT9	Several resources are included in the Travel Information Packs, including a map of local facilities, map of the Blunsdon Heritage Trail, extract of the Swindon Cycle Map, a map of the route and times of bus service 16 serving Blunsdon, together with information and tips to encourage sustainable travel modes. In addition, a Travel Information Newsletter was provided to residents and the Sales Office during the January 2025 which provided information on local facilities, updates regarding the Governments “bus fare cap”, guided group bike rides and a reminder that a free 1- week bus pass is available to residents and details of SBC’s ‘borrow a bike scheme’ and how residents can apply. The Travel Information Newsletter is attached at Appendix B .
Keep annual records of participation levels in sustainable travel schemes and incentives	M1	Residents are encouraged in the Travel Information Pack to email the TPC if they are interested in any of the RTP’s schemes or incentives. A record was kept of the number of people visiting the Sustainable Travel Event in October 2023 and those getting their bikes security marked; a total of 16 bikes were security marked .
Annual Monitoring Report	M5	Annual monitoring report produced covering the 12-month period (July 2024-July 2025).

Travel Information Packs

- 2.2. The on-line Travel Information Packs were reviewed and updated periodically throughout the past year (July 2024, December 2024, April 2025 and July 2025) to ensure that the traffic information provided was up to date; this included updates to bus service timetables, policy changes etc. The Travel Plan Coordinator (TPC) provided hard copies of the Travel Information Pack to the sales office on-site; these were also available online via the bespoke 'Swindon Travel Choices' website <https://www.swindontravelchoices.co.uk/newdevelopments/backhouse-blunsdon/>.
- 2.3. The TPC ensured that the sales staff were aware of the content of the Travel Information Packs and were fully briefed about the opportunities for sustainable travel which could be disseminated to the new residents.
- 2.4. Backhouse Blunsdon sales office have confirmed that the Travel Information Packs were handed out to new residents on occupation. Regular contact with the sales office has been maintained throughout the year to understand occupation numbers and to answer any queries about the RTP.
- 2.5. The Travel Information Packs continue to include promotion of the free 1-week bus tickets and the SBC 'borrow a bike scheme' which is available to all residents. The most recent on-line version of the Travel Information Pack continues to be available to residents; a copy of which is included at **Appendix A**.
- 2.6. As the Travel Information Packs are regularly updated, the TPC produced a poster to display in the sales office so that residents are able to access the latest version by means of a QR code. The poster, which is reproduced at **Appendix C**, also reminded residents of the free 1-week bus pass.

3. LOOKING AHEAD

- 3.1. The recommended 'next steps' for the Travel Plan Coordinator (TPC) to implement in the next 12 months as we get to full occupation of the development is set out below.

Updating Travel Plan on Modeshift STARS

- 3.2. The Backhouse Blunsdon Travel Plan shall be updated on Modeshift STARS to include a copy of this latest annual monitoring report. The TPC will review the Travel Plan Initiatives and where appropriate include further initiatives as required to work towards achieving the Bronze accreditation.

Engagement Events

- 3.3. The TPC's aim is to plan and undertake one or more public engagement events in 2025 following full occupation. This could be on-site or off-site similar to the event held in Blunsdon in 2023; it could include the attendance of Dr Bike to provide bike servicing/maintenance, and the offer bike security marking. If possible, a guided bike ride could also be arranged, or details of local rides shared with residents.

Travel Information Packs

- 3.4. The Travel Information Packs will be updated as required and provided to the Backhouse sales team to distribute. The on-line version will also be updated as and when any information changes and made available on the Backhouse Blunsdon Travel Information page on the 'Swindon Travel Choices' website.

Cycle and Bus Incentives

- 3.5. As uptake of the free 1-week bus pass has been low; the TPC will ensure residents are aware of this incentive and efforts will be made to improve its promotion within a newsletter to all residents following full occupation.
- 3.6. Information on local cycle and bus routes could also be provided within a newsletter to specifically highlight these opportunities to encourage a shift to these modes of travel.

Travel Surveys & Monitoring

- 3.7. Travel surveys of residents are to be undertaken following full occupancy. The timing and content of the travel survey is to be agreed with SBC's Travel Plan Officer. The Travel surveys will gather information about resident's travel patterns and feedback their views on what support could be offered to help them travel in more sustainable ways.
- 3.8. The results of the travel surveys will be reported in the annual monitoring report (July 2022-July 2026) and will be used to see whether the travel plan targets are being achieved or whether further measures are needed to encourage sustainable travel by the residents.

Accreditation

- 3.9. The aim for next year is for the Backhouse Blunsdon Travel Plan to achieve the 'Very Good Travel Plan' Bronze accreditation, by meeting the necessary criteria set out on Modeshift STARS, which will need the approval of SBC's Travel Plan Officer. This will involve the completion of further travel plan initiatives.

BACKHOUSE BLUNSDON WELCOME PACK

Helping you get around
your new area

OFFERS!

BORROW A BIKE

LEARN TO CYCLE LESSONS

FREE 1-WEEK BUS PASS

See inside
for details



BACKHOUSE



INSIDE YOUR WELCOME PACK

As part of the planning process, a Travel Plan has been developed for **Backhouse Blunsdon** to support residents in getting around in more sustainable ways such as walking, cycling and car-sharing.

This **Travel Information Pack** forms part of the Travel Plan providing local information and offers to help you explore your new neighbourhood and save money on travel.

BENEFITS TO YOU

There are many positive benefits of sustainable travel for you and your community including:

- ✓ Improving your health and well-being
- ✓ Reducing your travel costs
- ✓ Improving your access to local services
- ✓ Improving road safety
- ✓ Reducing your travel times
- ✓ Improving your travel choices
- ✓ Creating a cleaner, more vibrant local community

For more information, contact Harry Pearce the Backhouse Blunsdon Travel Plan Coordinator:

tpc@pfaconsulting.co.uk

Page 3
YOUR WELCOME LETTER

Page 4
YOUR LOCAL AREA
and local facilities

Page 6
WALKING
and places of interest within walking distance

Page 8
CYCLING
with information on local cycle routes

Page 10
BUS AND COACH TRAVEL

Page 12
RAIL TRAVEL

Page 14
DRIVING
Including information on car sharing

Page 15
OFFERS!

BACKHOUSE

Dear Resident,

WELCOME TO BACKHOUSE BLUNSDON!

We hope that you are settling into your new home and getting to know your local area. This Travel Information Pack provides you with useful information regarding travelling in and around Blunsdon and aims to help residents travel in greener, healthier ways and reduce journeys by car.

To help you along the way, Backhouse and Swindon Travel Choices are offering the chance to **borrow a bike for FREE for 6 weeks**. Choose between a hybrid bike, electric bike or folding bike with equipment such as child seats and pannier bags.

Looking to improve your confidence on two wheels? We can also arrange **FREE learn to cycle and cycle confidence sessions** for all the family. Check out page 9 to find out more.

There's also the chance to get hold of a **FREE 1-week bus pass** to try out local services (see page 11 for more information).

If you need help with journey planning or to find out about upcoming events, take a look at the Swindon Travel Choices website www.swindontravelchoices.co.uk/newdevelopments/backhouse-blunsdon/



For any other questions, please email: tpc@pfaconsulting.co.uk or phone PFA on 01793 828000 and ask for Harry Pearce, the Travel Plan Coordinator for Backhouse Blunsdon.

Happy exploring!

Harry Pearce, PFA Consulting
Your Travel Plan Coordinator



YOUR LOCAL AREA



Photo: facebook.com/blunsonvillageshop

A Community Shop and Cafe



Photo: whatpub.com/pubs

B Heart In Hand Pub



C Village Hall and Pre School



D Blunson House Hotel & Golf Course

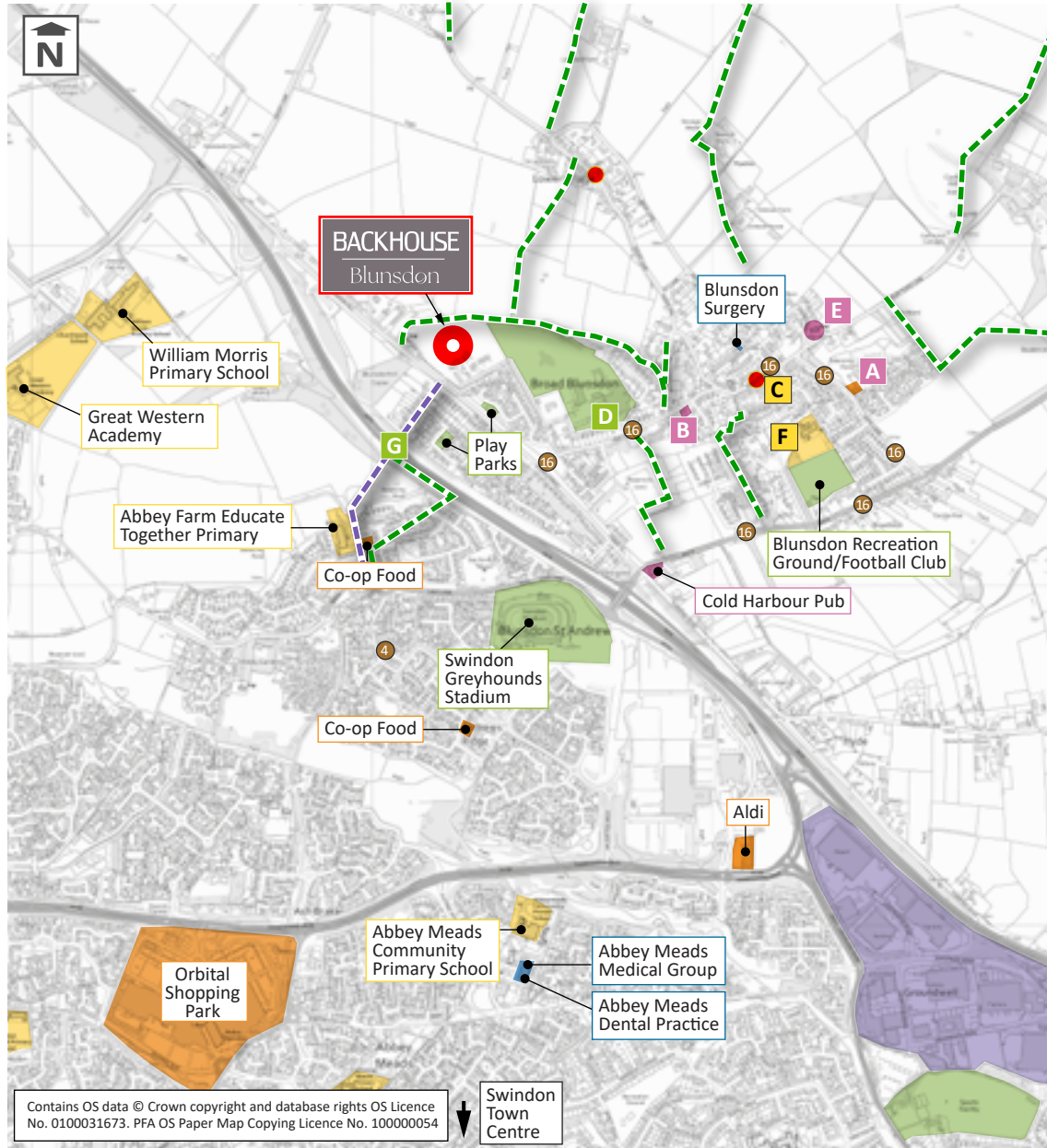

E St Leonard's Church



F St Leonard's CE Primary Academy



G Widhill Lane Bridleway Bridge

	Employment		Bus stop
	School		Post box
	Leisure		Footpath
	Medical Centre		Bridleway
	Supermarket/Retail		
	Community		

0 500m

Contains OS data © Crown copyright and database rights OS Licence No. 0100031673. PFA OS Paper IMap Copying Licence No. 10000054

Swindon Town Centre

WALKING

Blunsdon by Foot

Walking is the greenest, healthiest and cheapest way of getting around. It's a great way to fit regular exercise into your day, there is no waiting around, no congestion and it's absolutely free!

So why not try discovering the area around Blunsdon by foot? The village primary school, pre-school, village hall, shop and pub are all within walking distance and the wider facilities of North Swindon are easily accessible nearby.

Looking for somewhere to Walk the Dog or take a Countryside Stroll?

Blunsdon is well connected to the beautiful local countryside and there are plenty of nice places to visit within walking distance.

To discover the wide network of local footpaths, bridleways and byways take a look at the "My Maps" tab on Swindon Borough Council's website: <https://maps.swindon.gov.uk/sbcattmycouncil.aspx> or for other local areas to walk in take a look at the All Trails website: <https://www.alltrails.com/en-gb/trail/england/wiltshire/lower-blunsdon-circular?search=true>

A "Get Walking" magazine covering North Swindon can be downloaded from <https://www.swindontravelchoices.co.uk/wp-content/uploads/2021/05/Get-Walking-North-FINAL.pdf> and there are some useful interactive maps on the Swindon travel Choices website: <https://www.swindontravelchoices.co.uk/getting-around/walking/walking-routes/>

For a longer walk why not explore **Stanton Park** which is accessible along Kingsdown Lane. This beautiful 74-hectare country park and nature reserve features open green space, woodlands, meadows, ponds and streams.



Photo: Nick Howard 2020

Stanton Country Park



Photo: Justin McG 2022

Stanton Country Park

The Blunsdon Heritage Trail

The Blunsdon Heritage Trail takes a circular route around the Village following ancient paths and roads and the escarpment upon which Blunsdon has developed over the centuries. Enjoy the great views across the countryside from Castle Hill Hillfort!



- 1 The Cold Harbour Pub
- 2 Bydemill Brook
- 3 Historic Kingsdown Lane
- 4 Dismantled Railway
- 5 Anti-Aircraft Battery/Milestone
- 6 Castle Hill Hillfort
- 7 Broad Blunsdon Church
- 8 Lower Blunsdon Village
- 9 Blunsdon Ridge
- MS Mile Stone

Useful Walking Apps

- MapmyWalk
- NHS Active 10 Walking Tracker
- Pedometer
- OS Maps



Useful Websites

- www.swindontravelchoices.co.uk/walking
- <https://beta.ramblers.org.uk/go-walking/wellbeing-walks>
- <https://www.plotaroute.com/>



Co-op, Diamond Crescent, Abbey Farm



Village Hall

CYCLING

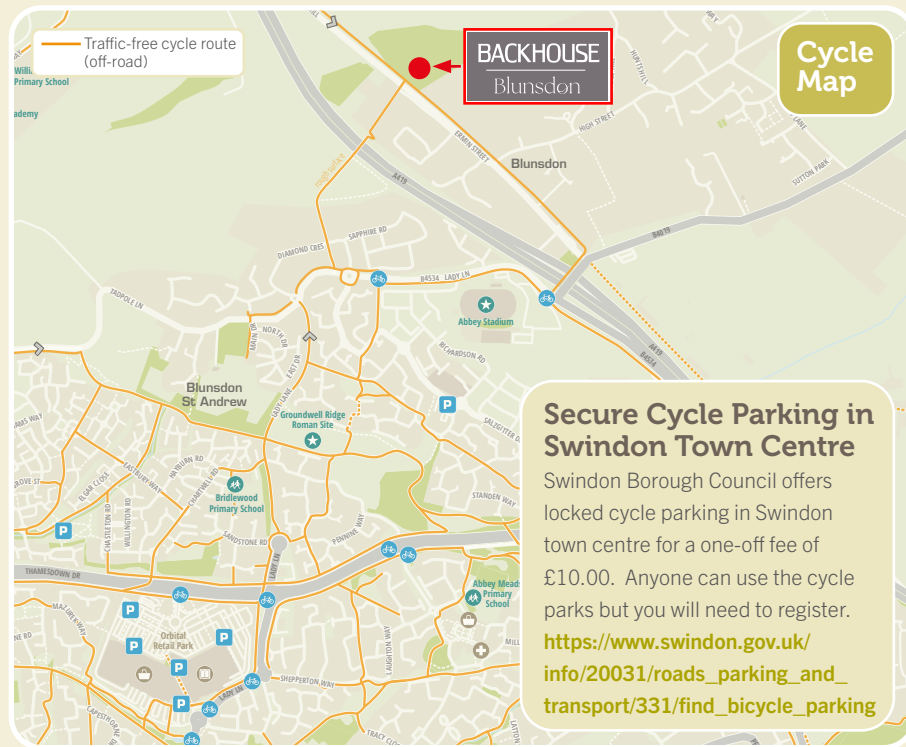

Secure Cycle Parking in Swindon Town Centre

Swindon Borough Council offers locked cycle parking in Swindon town centre for a one-off fee of £10.00. Anyone can use the cycle parks but you will need to register. https://www.swindon.gov.uk/info/20031/roads_parking_and_transport/331/find_bicycle_parking

Useful Cycle Map Links

For more information about cycling locally see the **Swindon Travel Choices** website www.swindontravelchoices.co.uk/getting-around/cycling



Get yourself a free copy of the **Swindon Cycle map** to help you navigate Swindon by bike or download an app such as **Cyclestreets**, **Strava** or **MapmyRide**.



To join free guided bike rides in the area or find a good traffic-free route from your doorstep take a look at **British Cycling's Let's Ride** site www.letsride.co.uk



FREE Family Learn to Cycle and Cycle Confidence Sessions

Would you like to **learn to cycle or develop confidence on a bike** so that you could cycle to school or work? Join one of the free upcoming events in Swindon. Secure your place here: <https://www.eventbrite.co.uk/o/swindon-cycle-campaign-61575400583>

We can also arrange **free cycle training** for anyone in the family at a time and date that suits you.

Get in touch with us for more information and to book on tpc@pfapl.com



Swindon Cycle Campaign

Would you like to help improve cycling in Swindon and the surrounding area? Why not get involved in Swindon Cycle Campaign, a collection of local volunteers working to make cycling easier and safer for everyone in the area. See the website for details: www.swindoncyclecampaign.org or follow on Facebook.

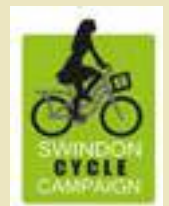

Borrow a Bike Scheme

Backhouse are offering your household a chance to try cycling for **FREE** for 6 weeks.

Choose between a hybrid bike, electric bike or folding bike.



For more details and to apply go to www.swindontravelchoices.co.uk/borrow-a-bike-scheme/

Bike Shops and Repairs

Swindon Cycles
www.swindoncycles.co.uk

Mitchell Cycles
www.mitchellcycles.co.uk

E-motion (electric bikes)
<http://e-motionevc.co.uk>

Recycles (refurbished bikes)
www.recycles-swindon.co.uk

The **Mobile Cycle Medic** offers a **mobile bike repair service** with pick up and drop off from your doorstep. <https://www.mobilecyclemedic.com/>

BUS AND COACH TRAVEL

Your nearest bus stops are located on the High Street and Hillside Way. **Stagecoach Service 16** operates a service every 90 minutes (approx) to Swindon Town Centre. A more frequent **Stagecoach Service 10** runs to Swindon Town Centre every 30 minutes from Thornhill Drive. The nearest Service 10 bus stop is a 12-15 minute walk south of Backhouse Blunston on Thornhill Drive - it can be accessed via the bridleway opposite the site www.stagecoachbus.com

Local Bus Services from Blunston

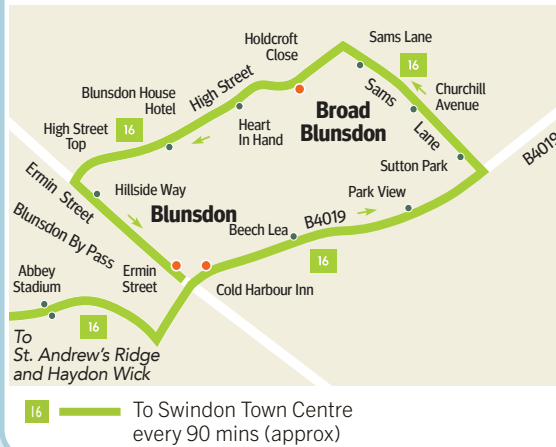

Travelling Further Afield?

National Express and **Megabus** run services from Swindon, offering a range of destinations across the UK.

National Express Service 401 travels between Bristol and London, operating approximately every two hours, Monday to Sunday. Buses stop at Swindon Bus Station/Great Western Hospital/Marlborough Rd and Sussex Square.

Megabus offers services from Swindon to over 20 UK-wide destinations with bus stops at Stratton Park, Sainsburys/Dunelm.



FREE 1-Week Bus Pass!

Backhouse is offering a **FREE 1-Week Bus Pass** as a special offer for residents to try out the local bus services.



To find out more and apply contact the Travel Plan Coordinator at: tpc@pfapl.com

Save Money

Have you reached state pension age or do you have a disability?

If so, you may be eligible for a concessionary bus pass from Swindon Borough Council. This is a free bus pass that allows you to travel on most Stagecoach buses for free. For more information, visit www.swindon.gov.uk/info/20031/roads_parking_and_transport/332/concessionary_bus_pass_and_travel_vouchers

Useful Apps for Smartphones and Tablets



Stagecoach



National Express



Traveline



UK Bus Checker



Photo: Swindon Borough Council

Proposed Swindon Bus Boulevard

£3 Price Cap on Single Bus Fares!

To help with the cost-of-living pressures the Government is subsidising most single bus fares to just £3 until 31st December 2025.



RAIL TRAVEL

Rail travel provides a fast and convenient option for travelling further afield. It can not only be quicker than travelling by car, but can also save you money in parking charges!

Swindon Station is the closest railway station, located 6 miles from Backhouse Blunsdon. The station offers frequent services to a wide range of destinations. Trains to London Paddington run approximately every 15 minutes, with half-hourly trains to Bristol and Cardiff and hourly trains to Cheltenham Spa. Cycle and car parking is available. Bikes travel free on trains but non-folding bikes must be pre-booked on the high speed services.

Stagecoach Services 16 & 10 run from Blunsdon to Swindon Bus Station, which is just a short walk from Swindon Railway Station.

Save Money

Aged over 60 or between 16 and 30? You can save a third off most rail fares with a railcard.

Travelling as a family? With a Family Railcard you can get a third off standard class adult rail fares and 60% off standard class child rail fares for up to four adults and four children.

For more information, visit the www.railcard.co.uk website.

Travelling as a group? Groups of three to nine adults can travel with a 34% discount using a Group Save ticket. More details can be found on the National Rail website.

If you book early you can save up to 85% on your rail journey using advance fares.



Photo © Brian Robert Marshall (cc-by-sa/2.0)



Stay Informed

Journey planning assistance can be found on www.swindontravelchoices.co.uk/plan-a-journey

Live departures and arrivals for all UK rail stations are available from www.nationalrail.co.uk

Alternatively, call **08457 48 49 50**

Useful Apps



The Trainline



Traveline



Great Western Railway



Photo: www.swindontowncentre.co.uk

DRIVING

When driving is the only option there are still ways that you can save money and reduce your carbon footprint.

Eco-driving more efficiently is an easy change to make. To learn some simple techniques visit: www.theaa.com/driving-advice/fuels-environment/drive-economically



Car Sharing

Car sharing provides the convenience of the car, whilst alleviating the associated problems of congestion and pollution. It is a great way to save money and reduce your emissions, while providing a fun way of meeting new people.



Your employer may run a car share scheme or offer priority parking and other incentives for car sharers. If you share daily on a 20 mile (each way) commute, you could save over £1,500 on fuel per year*!

Alternatively, find a car share partner by visiting the Swindon Carshare service at: www.carshareswindon.com The website is part of the Liftshare network which matches regular drivers with those on similar routes. There are currently over 700,000 members on Liftshare, so the chances are that you'll find a match. The scheme is completely free to join and use. You do not need to own a car as you can register as a potential passenger and share the fuel costs with someone driving. You can be flexible and don't have to car share every day.

**Based on two people sharing in a car with a petrol engine size between 1.4 and 2.0 litres with petrol costs at £1.65 per litre.*



Electric Vehicles

Electric vehicles are a more sustainable option if you do need to drive. Grants are available to reduce the cost of purchasing electric vehicles, visit www.swindontravelchoices.co.uk/getting-around/car/electric-vehicles/electric-vehicle-grants for more information. You don't have to apply for the grant – the dealer will include the value of the grant in the vehicle's purchase price at the point of purchase.

Charging Station Locations

Take a look at Zapmap to find your nearest charging station
zap-map.com/live/



Making an Irregular Journey?

Visit www.blablacar.com where you can either choose to travel in somebody else's car, or advertise your journey for other people to book seats on. A rating system ensures that members will always be confident and comfortable planning a car share. Furthermore, it is a great way to save money on long distance or one-off journeys.



Dont Forget to Take Advantage of Your OFFERS!

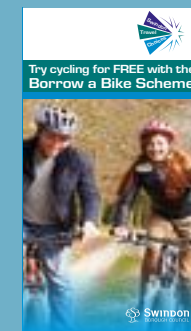

Further Information

We hope that the information in this leaflet has been useful for you.
If you have any queries or feedback, please contact
Harry Pearce, your Travel Plan Coordinator:

PFA Consulting
E: tpc@pfaconsulting.co.uk
T: 01793 828 000





Travel Plan Newsletter

BACKHOUSE, BLUNSDON

Dear Resident

Welcome to the Travel Plan Newsletter for Backhouse Blunston. Here you'll find information regarding exploring your local area in more sustainable ways, including:

- Local walking & cycling groups and places to explore
- A reminder about the free 1-week bus pass or free cycle lessons
- Other helpful tips & advice

Price Cap on Single Bus Fares!

Since the New Year, the single journey bus fare cap has increased to £3 until the **31st December 2025**. Hop on your local bus services today as bus travel remains an **affordable** way to travel around your local area!

What are my local bus services and where do I catch the bus from?

Stagecoach Service 16 operates a service from **Ermin Street** bus stop every 90 minutes to **Swindon Town Centre**.

A more frequent **Stagecoach Service 10** runs to **Swindon Town Centre** every 30 minutes from **Thornhill Drive**, accessible via a 10-12 minute walk via the bridleway opposite the development along Widhill Lane.

Did you know that Swindon Travel Choices has a range of useful information including cycling tips for beginners, safe cycling over the winter period, basic bike maintenance and an interactive Swindon Cycle Map!

Visit www.swindontravelchoices.co.uk/newdevelopments/badbury-park/



BACKHOUSE

Have you explored these local facilities near Backhouse?



Blunston Community Shop & Cafe

If you have not before, why not **walk or cycle** to the **Blunston Community Shop & Cafe** located on **Blunt Rise**, about a **12-15 minute** walk away from Backhouse.

It is a great place to grab some food or relax with friends and enjoy a coffee and snacks. Follow their Facebook page for the latest information about upcoming events and offers!

Co-op, Diamond Crescent, Abbey Farm

The nearest supermarket to Backhouse Blunston is a **Co-op at Abbey Farm**, approximately a **6 minute** walk away. It is accessible via the **byway** opposite the Backhouse development.



For free guided led rides, keep a eye on the **British Cycling Let's Ride** site <https://www.letsride.co.uk/>



The **Swindon & North East Wilts Ramblers** group often offer **group walks** in the local area. Find more information at: <https://www.ramblers.org.uk/>



If you enjoy these walks and wish to find more routes, consider becoming a member for just £3.58 per month.

If you are interested in any of the vouchers below, please find more information in your Travel Information Pack at <https://www.swindontravelchoices.co.uk/newdevelopments/blunston/> or email tpc@pfapl.com for information on how to apply.



Dear Residents, of Backhouse Blunsdon

Please find your bespoke **Travel Information Pack** via the QR Code below:



Your **Travel Information Pack** contains:

- Information on helping you to **walk, cycle** and use **public transport** more regularly around your local area
- Maps showing **walking and cycling routes** available from your doorstep
- Steps on how you can claim your FREE Stagecoach one week bus pass and how you can join the six week **“Borrow a Bike”** scheme

Alternatively, you can access your **Travel Information Pack** on the **Swindon Travel Choices** website:
<https://www.swindontravelchoices.co.uk/newdevelopments/backhouse-blunsdon/>



For personalised travel planning or if you have any questions please contact tpc@pfapl.com

BACKHOUSE



 **Stagecoach**